



# DTK-120/240HD2

Type 1 Surge Protective Device

DITEK's **DTK-120/240HD2** is engineered to be the finest 120/240V surge protector in its class. It incorporates robust surge protection components and low let-through voltage in a compact package. LED diagnostics provide positive indication of surge protection status. The HD2 series is perfect for residential or small commercial building surge protection.



## PRODUCT FEATURES

- Thermally-protected MOV technology
- Compact size enables close mounting to the protected equipment
- Diagnostic LED provides positive indication of system power and SPD function
- NEMA Type 4X polycarbonate enclosure
- UL 1449 Listed Type 1 SPD
- \$25,000 5-year residential connected equipment warranty

## APPLICATIONS

- Residential Electrical Panels
- Sub Panels

## ACCESSORIES

- Flush mount kit P/N DTK-FMKHD2

TECHNICAL SPECIFICATIONS	
Service Voltage:	120/240Vac Split $\Phi$
Surge Current Rating:	100,000A per phase 50,000A per mode
Short Circuit Current Rating (SCCR):	100,000A
Nominal Discharge Current Rating ( $I_n$ ):	20kA
MCOV:	150V/300V
Voltage Protection Rating (VPR):	600V Line-Ground 1000V Line-Line 600V Line-Neutral 900V Neutral-Ground
Operating Frequency:	50/60Hz
Status Indication:	LED

DITEK Surge Protection, Largo, FL 33771 • Sales: 800-753-2345  
 Diteksurgeprotection.com • SPS-100036-001 Rev 18 05/26





# DTK-120/240HD2

Type 1 Surge Protective Device

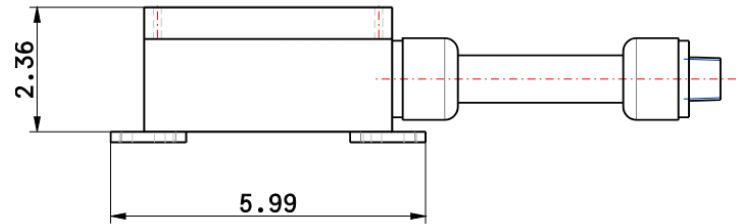
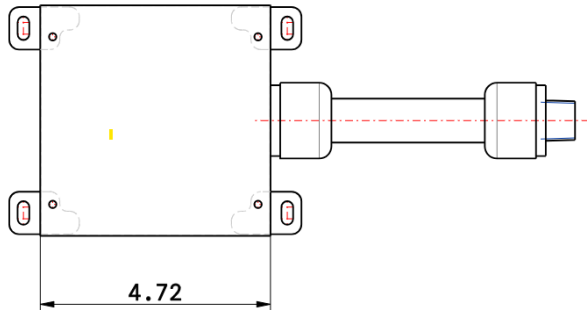

MECHANICAL SPECIFICATIONS	
Connection Method:	½" NPT non-metallic flexible conduit 30-inch 10AWG wire leads
Housing:	NEMA Type 4X polycarbonate
Operating Temperature:	-31°F – 140°F (-35°C – 60°C)
Maximum Humidity:	95% non-condensing
Dimensions:	4.72 in. L x 5.99 in. W x 2.36 in. H (121 mm x 152 mm x 60 mm)
Weight:	1.85 lbs. (0.84kg)

SAFETY STANDARDS AND CERTIFICATIONS	
Certifications:	UL 1449 5 <sup>th</sup> Edition Type 1 SPD CSA C22.2 No. 269.1-17, 2017-02 Type 1 SPD
Standards Compliance:	RoHS
Warranty:	10 Year Limited Warranty 5 Year \$25,000 Residential Connected Equipment Warranty