



DTK-120/240SA

Type 1 Surge Protective Device

DITEK's **DTK-120/240SA** residential Surge Protective Device is a powerful first line of defense against voltage surges and spikes. Its 50,000 Amp per Phase surge current rating provides strong protection when installed at locations such as the utility meter, main disconnect or household service panel. It can be used for indoor or outdoor applications.



PRODUCT FEATURES

- Thermally-protected MOV technology
- Compact size enables close mounting to the protected equipment
- Diagnostic LED provides positive indication of system power and SPD function
- NEMA Type 4X polycarbonate enclosure
- UL 1449 Listed Type 1 SPD

APPLICATIONS

- Residential Electrical Panels
- Electric Meter

ACCESSORIES

- Flush mount kit P/N DTK-FMKHD2

TECHNICAL SPECIFICATIONS

Service Voltage:	120/240Vac Split Φ
Surge Current Rating:	50,000A per phase 50,000A per mode
Short Circuit Current Rating (SCCR):	100,000A
Nominal Discharge Current Rating (I_n):	20kA
MCOV:	150V/300V
Voltage Protection Rating (VPR):	600V Line-Ground 1000V Line-Line
Operating Frequency:	50/60Hz
Status Indication:	LED

DITEK Surge Protection, Largo, FL 33771 • Sales: 800-753-2345
Diteksurgeprotection.com • SPS-100024-004 Rev 12 05/26





DTK-120/240SA

Type 1 Surge Protective Device

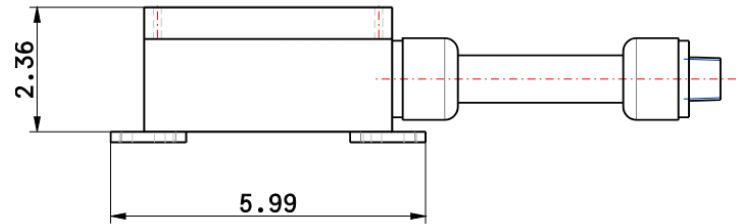
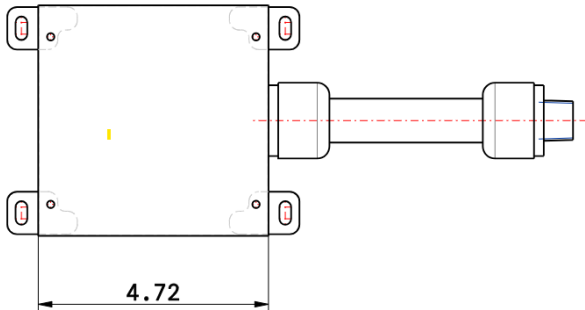

MECHANICAL SPECIFICATIONS	
Connection Method:	½" NPT non-metallic flexible conduit 30-inch 10AWG wire leads
Housing:	NEMA Type 4X polycarbonate
Operating Temperature:	-40°F – 140°F (-40°C – 60°C)
Maximum Humidity:	95% non-condensing
Dimensions:	4.72 in. L x 5.99 in. W x 2.36 in. H (121 mm x 152 mm x 60 mm)
Weight:	1.85 lbs. (0.84kg)

SAFETY STANDARDS AND CERTIFICATIONS	
Certifications:	UL 1449 5 th Edition Type 1 SPD CSA C22.2 No. 269.1-17, 2017-02 Type 1 SPD
Standards Compliance:	RoHS
Warranty:	10 Year Limited Warranty