



DTK-4LVTEP & DTK-4LVXR

Telephone Entry Surge Protectors

DITEK's DTK-4LVTEP & DTK-4LVXR are designed to protect commercial and residential gate entry systems. Both models provide protection for the power supply, telephone line, data and safety loop circuits.



PRODUCT FEATURES

- Protect power, data, telco and release circuits
- Series connection, parallel function adds no resistance to circuits
- Small form factor reduces installation space requirements

APPLICATIONS

- Telephone Entry Systems
- Gate Entry Systems

WIRING CONFIGURATIONS

- DTK-4LVTEP
12v power, 24v power, 130v telco, 5v data
- DTK-4LVXR
12/24v power, 24v release, (2) 130v telco

TECHNICAL SPECIFICATIONS

Service Voltage:	5Vdc Data	12Vdc Power	24Vdc Power	130Vdc Telco
MCOV:	6V	18V	33V	140V
Clamping Voltage:	8V	22V	39V	155V
Protection Modes:	Differential Mode (Line-Line) Common Mode (Line-Ground)			
Surge Current Rating:	5,000A			
Max. Continuous Current:	5 amps			

DITEK Surge Protection, Largo, FL 33771 • Sales: 800-753-2345
Diteksurgeprotection.com • SPS-100030-004 Rev 10 04/26





DTK-4LVTEP & DTK-4LVXR

Telephone Entry Surge Protectors

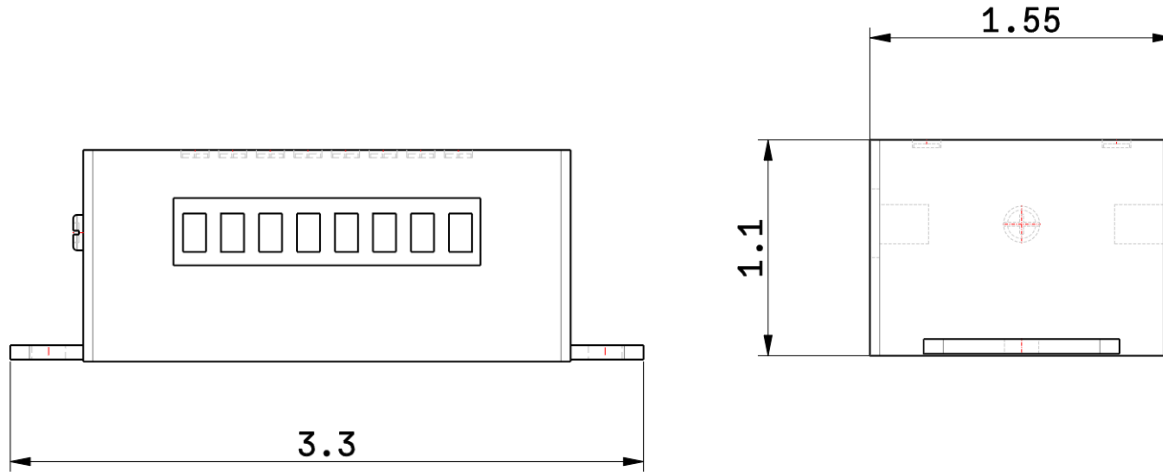

MECHANICAL SPECIFICATIONS	
Connection Method:	Screw terminals 30-12AWG
Housing:	ABS
Operating Temperature:	-40°F – 158°F (-40°C – 70°C)
Maximum Humidity:	95% non-condensing
Dimensions:	3.3 in. L x 1.55 in. W x 1.1 in. H (84 mm x 39 mm x 28 mm)
Weight:	3.2 oz (91g)

SAFETY STANDARDS AND CERTIFICATIONS	
Certifications:	UL 497B
Standards Compliance:	RoHS
Warranty:	10 Year Limited Warranty